

# PK082

## LED Light Pole Kit with Single LED Area Light, Selectable Wattage 185/240/300 & Color Temperature, 20-30 Foot Pole Height Options



Job: \_\_\_\_\_  
 Job Site: \_\_\_\_\_ State: \_\_\_\_\_ Client Name: \_\_\_\_\_  
 Notes: \_\_\_\_\_ Approvals: \_\_\_\_\_ Date: \_\_\_\_\_

### Commercial-grade LED Light Pole Assembly Includes:

Square steel light pole, Single LED light complete with mounting bracket and hardware, set of anchor bolts and a base cover.

#### Light Pole:

**Pole Shaft:** Commercial grade steel with minimum yield strength of 55,000 psi.

20 ft. poles: 4" square X 11 gauge; 25 ft. poles: 4" square X 7 gauge;  
 30 ft poles: 5" square X 7 gauge.

**Pole Height:** Standard pole height is 20 ft. Optional heights are 25 ft. and 30 ft. Custom heights are also available.

**Anchor Bolts:** A set of 4 galvanized steel anchor bolts is provided.

Each anchor bolt includes 2 nuts and 2 washers.

**Bolt Circle:** 4"sq. Pole: 8-1/2" Bolt Circle (Bolt Circle range: 8"-11").

30 ft poles: 11" Bolt Circle (Bolt Circle range: 10.5" - 12")

**Handhole:** Handhole is located 18" above the base plate for 20 ft and 25 ft pole. 21" above the base plate for 30 ft pole.

A 3" X 5" steel handhole cover is included.

**Color:** Dark Bronze

**Base Cover:** ABS Plastic base cover with rivets.

#### LED Fixture:

**Material:** Aluminum construction with integrated fins to maximize heat dissipation.

**Color:** Dark Bronze.

**Preset Power:** 300 Watts

**Voltage:** 120-277 Volt standard.

**Preset Color Temperature:** 5000K

**Light Distribution:** Type 3 standard.

Type 4 and Type 5 options as special order.

**Photocell:** Photocell is optional.

**Dimming:** 0-10V Dimming Capable.

Dimming control not provided (field install).

**ETL Listing:** ETL Listed for Wet Locations.

**DLC Listing:** DLC Premium.

**IP Rating:** IP65

**EPA Rating:** 0.55

**Warranty:** 5 Years.

**Weight:** 16 lbs.

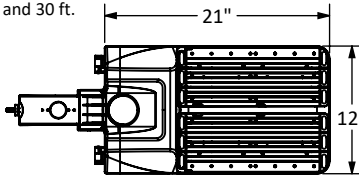

LED Fixture

Top view

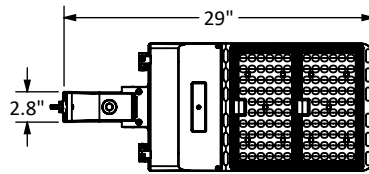

LED Fixture

Bottom View

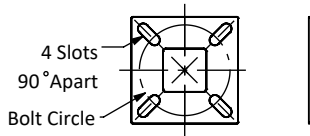

Base Plate

Pole Height	Base Plate Dim	Slot Dim	Bolt Circle
20 ft, 25 ft	10" Sq. x 0.75"	0.98" x 2.5"	8.5"
30 ft	11" Sq. x 1"	1.15" x 1.9"	11.0"

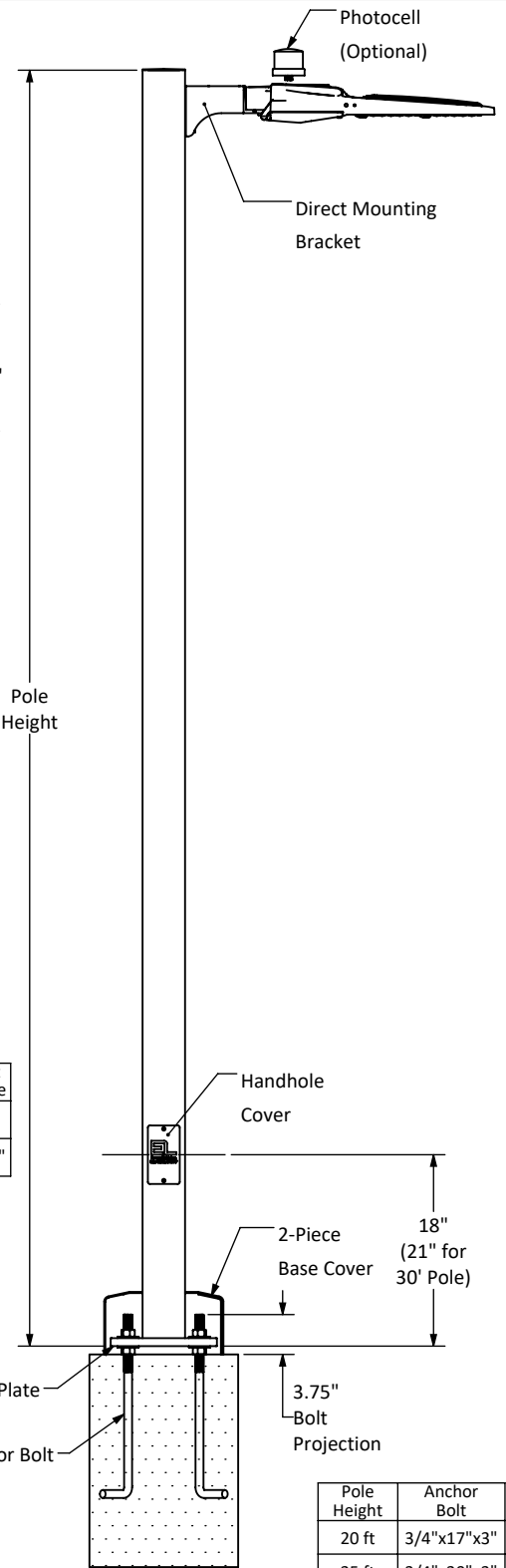

POWER (W)	LOW			MID			HIGH		
	185	240	300	185	240	300	185	240	300
AMPS	1.62 @ 120V/ 0.70 @ 277V			2.11 @ 120V/ 0.91 @ 277V			2.63 @ 120V/ 1.14 @ 277V		
COLOR TEMPERATURE (K)	3000	4000	5000	3000	4000	5000	3000	4000	5000
LUMENS	26,825	29,600	27,750	34,800	38,400	36,000	43,500	48,000	45,000
LUMENS/WATT	145	160	150	145	160	150	145	160	150

Pole Height	Anchor Bolt
20 ft	3/4"x17"x3"
25 ft	3/4"x30"x3"
30 ft	1"x36"x4"

**Disclaimer:** All dimensions and specifications are subject to change without any notice. Light Pole Foundation should be designed by an engineer familiar with local soil and wind conditions as well as local code where the light pole will be installed.