

PK081

LED Light Pole Kit with Single LED Area Light, Selectable Wattage 100/150/185 & Color Temperature, 10-25 Foot Pole Height Options



Job: _____
 Job Site: _____ State: _____ Client Name: _____
 Notes: _____ Approvals: _____ Date: _____

Commercial-grade LED Light Pole Assembly Includes:

Square steel light pole, Single LED light complete with mounting bracket and hardware, set of anchor bolts and a base cover.

Light Pole:

Pole Shaft: 4 inch square 11 gauge (10 ft., 15 ft. and 20 ft.) and 7 gauge (25 ft.)

commercial grade steel with minimum yield strength of 55,000 psi

Pole Height: Optional heights are 10 ft., 15 ft., 20ft. and 25 ft.

Custom heights are also available

Anchor Bolts: A set of 4 galvanized steel anchor bolts is provided.

Each anchor bolt includes 2 nuts and 2 washers.

Bolt Circle: 8-1/2" (Bolt Circle range: 8"-11").

Handhole: Handhole is located 18" above the base plate.

A 3" X 5" steel handhole cover is included.

Color: Dark Bronze

Base Cover: ABS Plastic base cover with rivets.

LED Fixture:

Material: Aluminum construction with integrated fins to maximize heat dissipation.

Color: Dark Bronze.

Preset Power: 150 Watts

Voltage: 120-277 Volt standard.

Preset Color Temperature: 5000K

Light Distribution: Type 3 standard.

Type 4 and Type 5 options as special order.

Photocell: Photocell is optional.

Dimming: 0-10V Dimming Capable.

Dimming control not provided (field install).

ETL Listing: ETL Listed for Wet Locations.

DLC Listing: DLC Premium.

IP Rating: IP65

EPA Rating: 0.55

Warranty: 5 Years.

Weight: 10 lbs

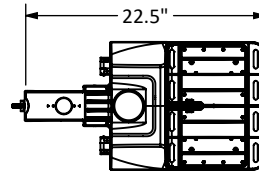

LED Fixture
Top View

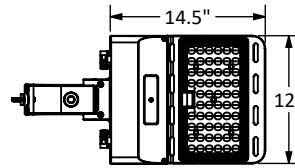

LED Fixture
Bottom View

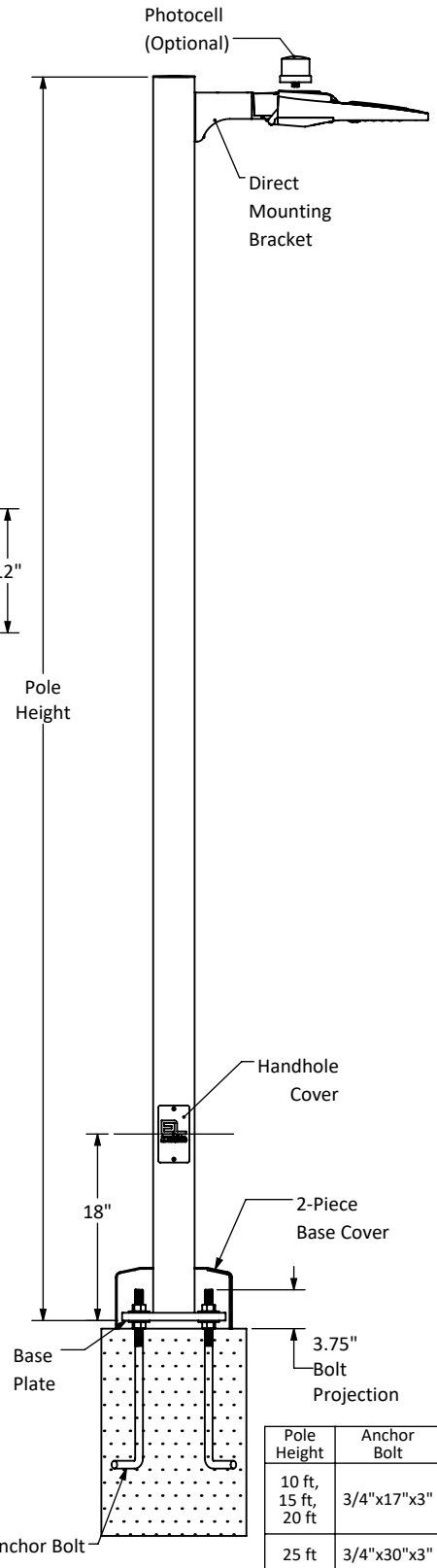
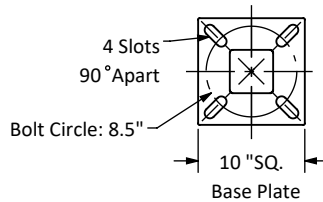
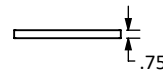

POWER (W)	LOW			MID			HIGH		
	100	150	185	100	150	185	100	150	185
AMPS	0.87 @ 120V/0.38 @ 277V			1.31 @ 120V/0.57 @ 277V			1.62 @ 120V/0.70 @ 277V		
COLOR TEMPERATURE (K)	3000	4000	5000	3000	4000	5000	3000	4000	5000
LUMENS	14,500	16,000	15,000	21,750	24,000	22,500	26,825	29,600	27,750
LUMENS/WATT	145	160	150	145	160	150	145	160	150

Disclaimer: All dimensions and specifications are subject to change without any notice. Light Pole Foundation should be designed by an engineer familiar with local soil and wind conditions as well as local code where the light pole will be installed.